

# Zubehör

## Klapp-Winkel (metrisch, PG, NPT)

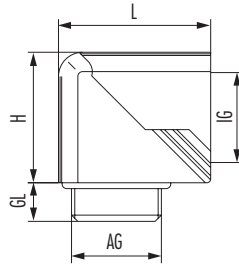

Material	Polyamid
Material O-Ring	NBR
Schutzart	IP 68
Temperaturbereich	-20°C bis +80°C
Farbe	grau / schwarz
RAL	7035 / 9005

RoHS

AG	IG	GL mm	H mm	L mm	Art.-Nr. grau	Art.-Nr. schwarz
M16 x 1,5	PG 9	8	23	28,5	1.315.1600.50	1.315.1601.50
M16 x 1,5	M16 x 1,5	8	23	28,5	1.316.1600.50	1.316.1601.50
M20 x 1,5	PG 13,5	9	30,5	35	1.315.2000.50	1.315.2001.50
M20 x 1,5	M20 x 1,5	9	30,5	35	1.316.2000.50	1.316.2001.50
M25 x 1,5	PG 21	11	40	49	1.315.2500.50	1.315.2501.50
M25 x 1,5	M25 x 1,5	11	40	49	1.316.2500.50	1.316.2501.50
M32 x 1,5	PG 29	11	51,5	60	1.315.3200.50	1.315.3201.50
PG 9	PG 9	8	23	28,5	1.315.0900.11	1.315.0901.11
PG 9	M16 x 1,5	8	23	28,5	1.316.0900.11	1.316.0901.11
PG 11	PG 11	8	27	31,5	1.315.1100.11	1.315.1101.11
PG 13,5	PG 13,5	9	30,5	35	1.315.1300.11	1.315.1301.11
PG 13,5	M20 x 1,5	9	30,5	35	1.316.1300.11	1.316.1301.11
PG 16	PG 16	10	32,5	37,5	1.315.1600.11	1.315.1601.11
PG 21	PG 21	11	40	49	1.315.2100.11	1.315.2101.11
PG 21	M25 x 1,5	11	40	49	1.316.2100.11	1.316.2101.11
PG 29	PG 29	11	51,5	60	1.315.2900.11	1.315.2901.11
NPT 3/8"	PG 9	15	23	28,5	1.315.3800.70	1.315.3801.70
NPT 1/2"	PG 13,5	13	30,5	35	1.315.1200.70	1.315.1201.70
NPT 3/4"	PG 21	13	40	49	1.315.3400.70	1.315.3401.70
NPT 1"	PG 29	19	51,5	60	1.315.1000.70	1.315.1001.70